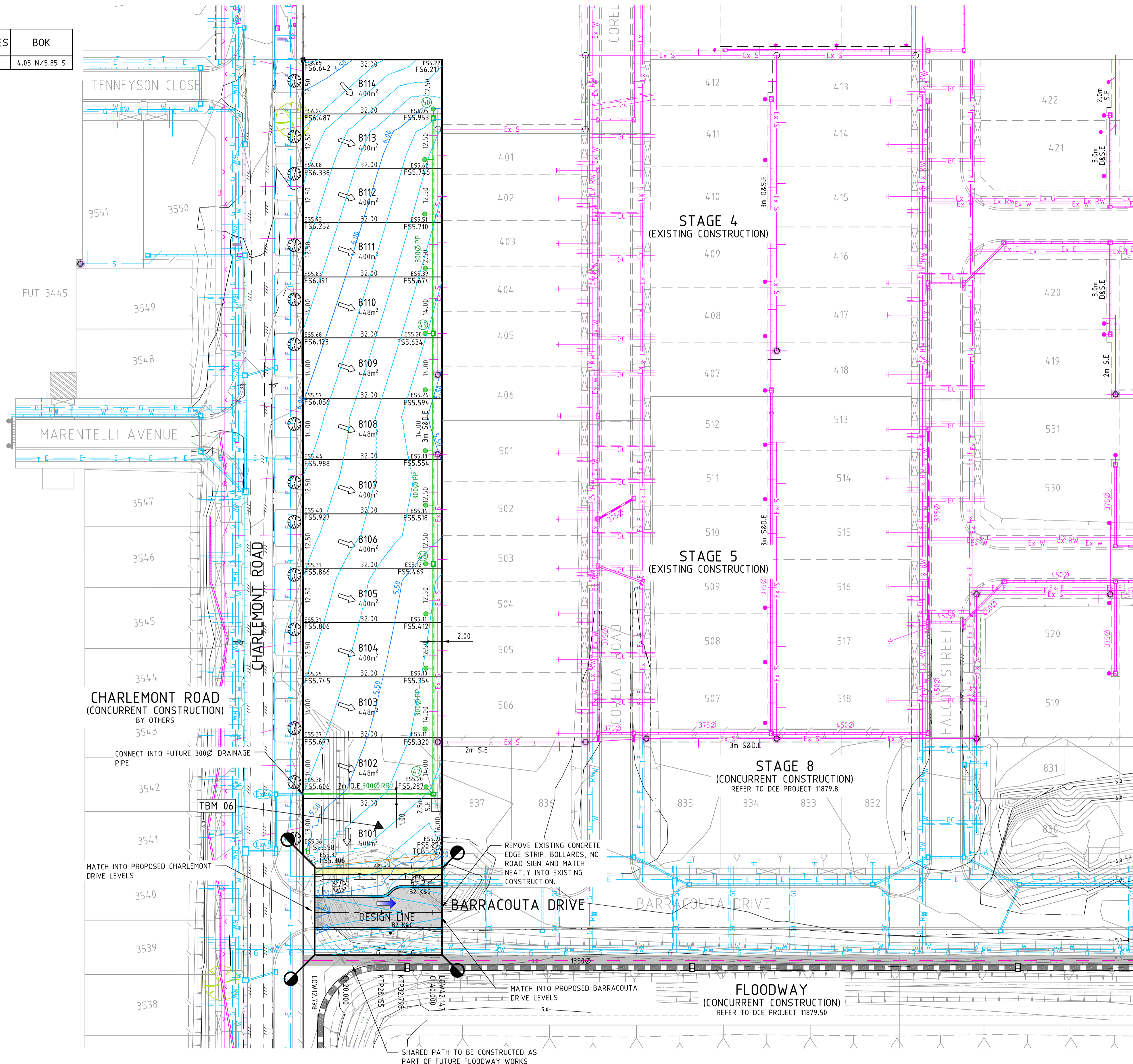

TABLE OF SERVICE LOCATIONS

STREET NAME	SEW	GAS	NDW	DW	COMS	ELEC	POLES	BOK
BARRACOUTA DRIVE	-	0.50 S	1.30 S	2.10 S	1.80 N	2.60 N	-	4.05 N/5.85 S



TBM SCHEDULE

I.D.	TYPE	EASTING	NORTHING	LEVEL
TBM 1	STAR PICKET	270264.42	5764328.43	3.82
TBM 2	RIVET	270340.71	5764364.07	3.40
TBM 3	STAR PICKET	270358.34	5764207.16	2.88
TBM 4	STAR PICKET	270330.52	5763980.77	2.85
TBM 5	STAR PICKET	270325.02	57663819.30	3.93
TBM 6	STAR PICKET	269950.68	5763884.66	5.16
PSM 1	PERMANENT MARK	270001.808	5763900.448	
PSM 2	PERMANENT MARK	270082.132	5763931.024	

NOTE: TBM'S
 TBM'S SHOWN IN THE TABLE ABOVE ARE OUTSIDE OF THE SCOPE OF THIS DRAWING. REFER TO SHEET 04 FOR LOCATION OF TBM'S IN RELATION TO STAGE 8A WORKS.

GREATER GEELONG CITY COUNCIL
 PLANNING ENVIRONMENT ACT 1987
 GREATER GEELONG PLANNING SCHEME

Endorsed Plan
 Planning Permit No: PP-273-2011/B
 Sheet 6 of 20
 Approved By Daniel Cromberge
 Approved Date 4/11/2022

NOTE: THIS IS NOT A BUILDING APPROVAL

Certification No: 15487

NOTE: EXISTING SERVICES
 ALL EXISTING SERVICES UNDER NEW AND PROPOSED ROAD PAVEMENT, FOOTPATH AND DRIVEWAYS TO BE FCR BACKFILLED.

NOTE: EXISTING STRUCTURES
 ALL EXISTING DRAINAGE PITS AND SEWER STRUCTURES WITHIN NEW WORKS ARE TO BE ADJUSTED TO MATCH NEW FINISHED SURFACE LEVELS.

BEWARE!
 TELSTRA OPTIC FIBRE CABLES IN THE VICINITY OF WORKS. TEL: 9253 8263.

CAUTION!
 TELSTRA MAJOR CABLES ARE IN THE VICINITY OF WORKS.

DANGER!
 OVERHEAD ELECTRICITY TRANSMISSION LINES. CONTRACTOR TO EXERCISE EXTREME CAUTION WHEN OPERATING IN THE VICINITY OF THESE LINES. THE CONTRACTOR MUST ADHERE TO ALL "NO GO ZONE" REQUIREMENTS OF THE POWER AUTHORITY.

WARNING!
 THE LOCATION OF EXISTING SERVICES SHOWN ON THESE PLANS MUST BE PROVEN ON SITE, THE APPROPRIATE AUTHORITY MUST BE CONTACTED AND THE SERVICES LOCATED PRIOR TO COMMENCEMENT OF ANY WORKS.

Drawing File: C:\2d\Synergy\GMA\ENERGY\MEL\11879.81-Armstrong Waters Stage 8A_232\3 Design\01_ACAD\4_8D\11879.81DP01.dwg - (DWG)
 Date/Time: Fri Nov 04, 2022 - 3:23pm - drceng

Drawn	B.ADAMS	10/05/22
Date	AN	2591087
Designed	J.SIVERSEN	11/05/22
Date	AN	4031015
Checked	R.MASON	12/05/22
Date	AN	705365
Approved		
Date		
AN		

LEGEND

-Ex W	EX. WATER MAIN	-E	CNR. ELECTRICITY	-T	TELECOMMUNICATIONS
-Ex RW	EX. RECYCLED WATER	-G	CNR. GAS	-G	GAS
-Ex G	EX. GAS MAIN	-W	CNR. WATER	-W	WATER
-Ex E	EX. ELECTRICAL CABLE	-RW	CNR. RECYCLED WATER	-RW	RECYCLED WATER
-Ex S	EX. SEWER MAIN & MH	-D	CNR. SW DRAIN & PIT	-D	LIMIT OF WORKS
-Ex T	EX. COMM. CABLE & PIT	-D/G	CNR. DW/NDW/GAS CONDUITS	-D	MAIN SW DRAIN & PIT
-Ex D	EX. DRAIN & PIT	-E	ELECTRICITY	-D	SW DRAIN & PIT
-Ex P	EX. O/H ELEC. & POLE	-B	BATTER		

155.0 FS CONTOURS
 REGRADE LOT (MN 1:50)
 O/D/O OVERFLOW DIRECTION
 PSM | TBM
 TREE
 ASPHALT PAVEMENT
 CONCRETE PATH | D'WAY
 FUTURE CONCRETE PATH

LAUREL GROVES ESTATE PTY LTD
 ARMSTRONG WATERS - STAGE 8A
 291-411 CHARLEMONT ROAD, CONNEWARRE
 CITY OF GREATER GEELONG
 DETAIL PLAN

Armstrong Waters

Coords: MGA Levels: AHD

Scale @ A1/A3 1:500 / 1:1000

BEFORE YOU DIG
 www.byda.com.au

DALTON CONSULTING ENGINEERS
 ABN 78 429 221 049
 QUEENSLAND
 T 61 7 3374 9000
 E info@dceng.com.au

VICTORIA
 T 61 3 9813 7400
 W dceng.com.au

CONSTRUCTION

Drawing No. 11879.81DP01 Rev 1
 Sheet No. 05 of 19